

ASSEMBLY PART NUMBER	CPA	COLOR	KEYING OPTION	DIMENSIONS (DEGREES)		CAVITY TYPE & STATUS (X=PLUGGED)													
				A	B	1	2	3	4	5	6	8							
33471-0601	-	BLACK	A	60	60														
33471-0602	-	LT. GRAY	B	60	30														
33471-0603	-	BROWN	C	30	60														
33471-0604	-	GREEN	D	30	30														
33471-0605	-	CUSTOM	TBD	TBD	TBD														
33471-0606	YES	BLACK	A	60	60														
33471-0607	YES	LT. GRAY	B	60	30														
33471-0608	YES	BROWN	C	30	60														
33471-0609	YES	GREEN	D	30	30														
33471-0610	YES	CUSTOM	TBD	TBD	TBD														
33471-0611	-	BLACK	A	60	60														X
33471-0612	-	LT. GRAY	B	60	30														X
33471-0613	-	BROWN	C	30	60														X
33471-0614	-	GREEN	D	30	30														X
33471-0615	-	CUSTOM	TBD	TBD	TBD														X
33471-0616	YES	BLACK	A	60	60														X
33471-0617	YES	LT. GRAY	B	60	30														X
33471-0618	YES	BROWN	C	30	60														X
33471-0619	YES	GREEN	D	30	30														X
33471-0620	YES	CUSTOM	TBD	TBD	TBD														X
33471-0621	-	BLACK	A	60	60	X													X
33471-0622	-	LT. GRAY	B	60	30	X													X
33471-0623	-	BROWN	C	30	60	X													X
33471-0624	-	GREEN	D	30	30	X													X
33471-0625	-	CUSTOM	TBD	TBD	TBD	X													X
33471-0626	YES	BLACK	A	60	60	X													X
33471-0627	YES	LT. GRAY	B	60	30	X													X
33471-0628	YES	BROWN	C	30	60	X													X
33471-0629	YES	GREEN	D	30	30	X													X
33471-0630	YES	CUSTOM	TBD	TBD	TBD	X													X
33471-0631	-	BLACK	A	60	60	X	X	X	X	X	X	X	X	X	X	X	X	X	X
33471-0632	-	LT. GRAY	B	60	30	X	X	X	X	X	X	X	X	X	X	X	X	X	X
33471-0633	-	BROWN	C	30	60	X	X	X	X	X	X	X	X	X	X	X	X	X	X
33471-0634	-	GREEN	D	30	30	X	X	X	X	X	X	X	X	X	X	X	X	X	X
33471-0635	-	CUSTOM	TBD	TBD	TBD	X	X	X	X	X	X	X	X	X	X	X	X	X	X
33471-0650	-	BLACK	A	60	60														X
33471-0651	YES	BLACK	A	60	60	X	X	X	X	X	X	X	X	X	X	X	X	X	X

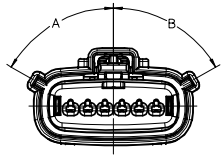

KEY OPTION  
SEE TABLE

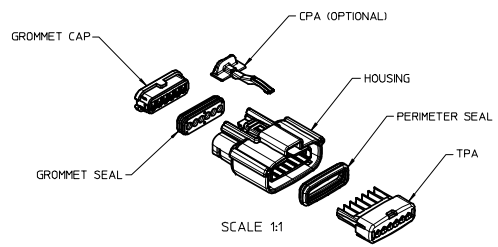

SCALE 1:1

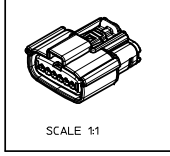

SCALE 1:1

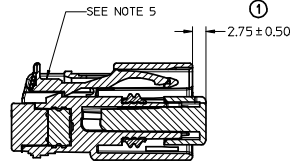

SECTION B-B  
(RECEPTACLE INSERT SHOWN  
IN PRE-LOCK POSITION)  
SEE NOTE #2

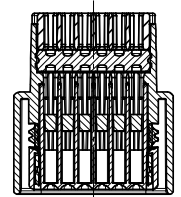

SECTION A-A

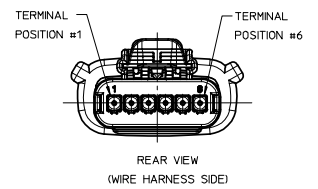

REAR VIEW  
(WIRE HARNESS SIDE)

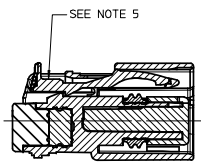

SECTION B-B  
(RECEPTACLE INSERT SHOWN  
IN FINAL-LOCK POSITION)  
SEE NOTE #2

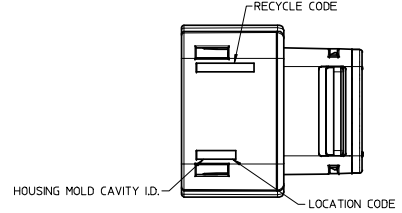
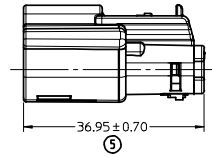
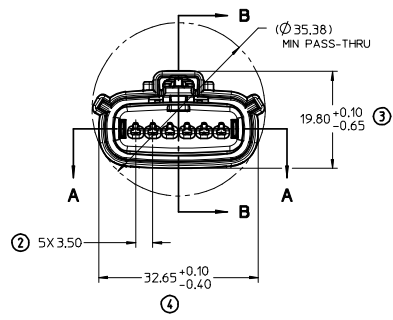

NOTES: UNLESS OTHERWISE SPECIFIED

- DESIGNED TO MATE WITH THE BLADE HOUSING ASSEMBLY SPECIFIED IN MOLEX CHARTERED DRAWING SD-33481-061 OR DEVICE CONNECTION AS SPECIFIED IN DRAWING E-33581-061.
- ASSEMBLY SHIPPED WITH RECEPTACLE INSERT IN PRE-LOCK POSITION (SEE SECTION B-B PRE-LOCK). UPON FULL TERMINAL ASSEMBLY, EACH RECEPTACLE INSERT MUST BE SNAPPED INTO ITS FINAL-LOCK POSITION.
- FOR RECEPTACLE TERMINALS TO BE USED WITH THIS ASSEMBLY. SEE MOLEX DRAWING SD-33012-002.
- SYSTEM TO BE USED WITH WIRE WITHIN DIAMETER RANGE OF 1.5mm TO 2.5mm.
- OPTIONAL CPA SHOWN IN ALL VIEWS. SEE TABLE FOR SPECIFIC ASSEMBLY OPTION AND NUMBER.  
CPA MUST BE INSERTED TO THE PRE-LOCK POSITION, AS SHOWN IN SECTION B-B. WHEN SEATED CORRECTLY, CPA DOES NOT MOVE FREELY. ENGAGEMENT FORCE TO MOVE CPA FROM PRE-LOCK TO FINAL LOCK POSITION WHEN UNMATED: 40N MIN. DISENGAGEMENT FORCE TO MOVE CPA FROM FINAL LOCK TO PRE-LOCK POSITION: 3N MIN.
- MATERIAL: SPS/NYLON BLEND, 20% GLASS FILLED.
- ASSEMBLIES SHALL CONFORM TO (BULK) PACKAGING SPECIFICATION PK-31300-635 ASSEMBLIES SHALL CONFORM TO (CELL PACK) PACKAGING SPECIFICATION PK-31300-903
- SHALL CONFORM TO PRODUCT SPECIFICATION PS-33471-000.
- PACKAGING: IN THE EVENT THAT INSERT IS FOUND IN THE SEATED (FINAL LOCK) POSITION, REFER TO MOLEX SPECIFICATION PS-34646-001, AVAILABLE AT WWW.MOLEX.COM.

INSPECTION NUMBER LOG  
LAST NUMBER USED: 5  
ADDED:  
REMOVED:

REDRAWN E.C. NO. UAU2009-0011 2008/08/14 DRWN:MOJCK 2008/08/19 CHKD:SVRZL 2008/08/21 APPR:WOSHY	QUALITY SYMBOLS ▽=0 ▽=0	GENERAL TOLERANCES (UNLESS SPECIFIED) mm INCH 4 PLACES ± --- ± --- 3 PLACES ± --- ± --- 2 PLACES ± 0.10 ± --- 1 PLACE ± 0.3 ± --- ANGULAR ± 3 °	DIMENSION STYLE MM ONLY DRAWN BY DATE DGR1FF1THS 06-03-03 CHECKED BY DATE DGR1FF1THS 06-03-03 APPROVED BY DATE DGR1FF1THS 06-03-03	SCALE 2:1 DESIGN UNITS METRIC THIRD ANGLE PROJECTION	TITLE MX150 STANDARD CONNECTOR RCPT 1 ROW HOUSING SEALED 6 WAY
	MATERIAL NO. SEE CHART DOCUMENT NO. SD-33471-061		MOLEX INCORPORATED		SHEET NO. 1 OF 1
	THIS DRAWING CONTAINS INFORMATION THAT IS PROPRIETARY TO MOLEX INCORPORATED AND SHOULD NOT BE USED WITHOUT WRITTEN PERMISSION				